

INVERSIONES

NIT 830.139.401-1 REGIMEN COMUN



MOTOR





MOTORREDUCTOR HELICOIDAL MONOFASICO - TRIFASICO

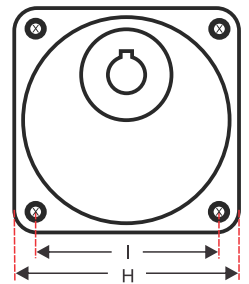
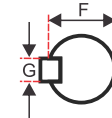
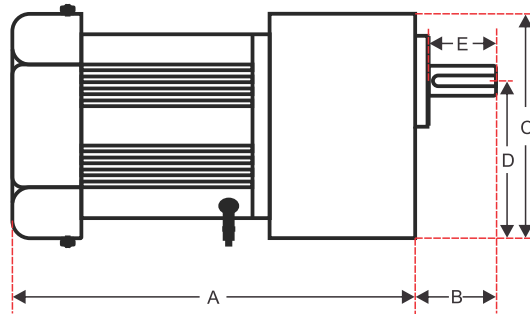

MOTORREDUCTOR HELICOIDAL MONOFASICO																		
REFERENCIA	VATIOS	RPM	VOLT	PH	HZ	Amp	Nm	CAPACITOR	PESO	A	B	C	D	E	F	G	H	I
4IK30GN-AF/200	30	9	110	1	60	0.65	7.8	8 UF	2.5	150	32	80	55	29	10	4	80X80	67
4IK30GN-AF/120	30	15	110	1	60	0.65	7.8	8UF	2.5	150	32	80	55	29	10	4	80X80	67
4IK30GN-AF/15	30	120	110	1	60	0.61	2.2	8UF	2.4	150	32	80	55	29	10	4	80X80	67
5IK60GN-AF/120	60	15	110	1	60	0.9	9.8	15 UF	3.9	190	32	90	62	26	12	4	90X90	74
5IK60GN-AF/30	60	60	110	1	60	0.95	7.3	15 UF	3.9	190	32	90	62	26	12	4	90X90	74
5IK60GN-AF/20	60	90	110	1	60	0.98	4.9	15 UF	3.8	190	32	90	62	26	12	4	90X90	74
5IK90GN-AF/120	90	15	110	1	60	1.2	19.6	20 UF	4.7	210	38	90	62	30	15	5	90X90	74
5IK90GN-AF/30	90	60	110	1	60	1.2	11	20 UF	4.7	210	38	90	62	30	15	5	90X90	74
6IK120GN-AF/120	120	15	110	1	60	1.9	39.2	25 UF	6.5	265	43	103	72	32	15	5	103X103	85

MOTORREDUCTOR HELICOIDAL MONOFASICO CON VARIADOR																		
REFERENCIA	VATIOS	RPM	VOLT	PH	HZ	Amp	Nm	CAPACITOR	PESO	A	B	C	D	E	F	G	H	I
5IK60RGN-AF/15	60	120	110	1	60	0.9	4.1	15 UF	3.8	190	32	90	62	26	12	4	90X90	74

MOTORREDUCTOR HELICOIDAL TRIFASICO																		
REFERENCIA	VATIOS	RPM	VOLT	PH	HZ	Amp	Nm	CAPACITOR	PESO	A	B	C	D	E	F	G	H	I
5IK60GN-SF/120	60	15	220	3	60	0.49	9.8	NO	3.8	190	32	90	62	26	12	4	90X90	74
5IK90GN-SF/30	90	60	220	3	60	0.66	11	NO	4.7	210	38	90	62	30	15	5	90X90	74